

Boeing Supplier Certification Instructions

Boeing suppliers certified by a 3rd party entity must upload a current certificate or approved artifact indicating a valid certification annually.

Only the following artifacts are approved for supplier certifications. Maps or any documentation not outlined below will not be accepted. A sample of each certificate/artifact and instructions for validation is provided on the following pages. Click on the links below to quickly navigate to the sample.

Category / Entity	Entity	Certificate Example
HUBZone Small Business	SBA	Dynamic Small Business Search (DSBS) Profile or SAM.gov Profile
Disability-Owned Business Enterprise (DOBE)	Disability: IN	Disability: IN Certificate
LGBT-Owned Business Enterprise (LGBTBE)	NGLCC	NGLCC Certificate
Certified Minority-Owned (U.S.)	NMSDC	NMSDC Certificate
Certified Minority-Owned (Non-U.S.): NMSDC affiliate	CAMSC (Canada) MSD-UK (UK) MSD-China (China) Supply Nation (Australia) SADC (South Africa) INTEGRARE (Brazil)	Various
Certified Women-Owned (U.S)	WBENC	WBENC Certificate
Certified Women-Owned (Non-U.S.)	WEConnect International	WEConnect Certificate
NVBDC-Certified Veteran-Owned	NVBDC	NVBDC Certificate

A sample of each artifact is provided on the following pages, along with instruction for capturing the full profile and download date from the Dynamic Small Business Search ([DSBS](#)) and SAM.gov web sites (for HUBZone certification only).

Thank you for your attention and action to prevent any delay in certification processing.

SAMPLES OF REQUIRED ARTIFACTS

HUBZone

Sample Dynamic Small Business Search (DSBS) full profile (pdf) with download date:

Validation: PDF must include the correct supplier name, header or footer must include print date within one year of previous year's HUBZone anniversary date and the "HUBZone certified?" box must be checked yes.

10/25/22, 12:24 PM

SBA - SBA Profile

SBA Profile

[Privacy Statement](#)
([Back to Profile List](#), or use Back button)

Identification, Location & Contacts

This profile was last updated: 07/26/2022
Status: Active

User ID: P0294093

Name of Firm: [REDACTED]
Trade Name ("Doing Business As ..."): [REDACTED]
UEI: [REDACTED]
Address, line 1: [REDACTED]
Address, line 2: [REDACTED]
City: [REDACTED]
State: [REDACTED]
Zip: [REDACTED]
Phone Number: [REDACTED]
Fax Number: [REDACTED]
E-mail Address: [REDACTED]
WWW Page: [REDACTED]
E-Commerce Website: [REDACTED]
Contact Person: [REDACTED]
County Code (3 digit): [REDACTED]
Congressional District: [REDACTED]
Metropolitan Statistical Area: [REDACTED]
CAGE Code: [REDACTED]
Year Established: 1998
Accepts Government Credit: Yes No
Card?: [REDACTED]
GSA Advantage Contract(s): [REDACTED]

(Note: Size information is now under "NAICS Codes with Size Determinations by NAICS", below.)

Organization, Ownership & Certifications

Legal Structure: Subchapter S Corporation
Ownership and Self-Certifications:

Current Principals

1. Jeff Gunnin, CFO
2. John Cunningham, Vice President

"Business Development Servicing Office" (for certifications)

https://web.sba.gov/pro-net/search/dsp_profile.cfm?RequestTimeout=60&SAM_UEI=C6CQLRB6GPW8

1/4

✓ Header or footer includes page print date within one year of previous year's HUBZone anniversary date



✓ “[X] Yes” must be checked
 ✓ No end date indicated

Instructions for capturing the full profile and download date from the Dynamic Small Business Search (DSBS) web site (Microsoft Edge):

1. Navigate to the Dynamic Small Business Search ([DSBS](#)) Website
2. Scroll down to the section labeled “Searching for a specific profile”
3. Enter your CAGE Code or UEI
4. Press “Enter” or scroll to the bottom of the page and click “Search Using These Criteria”
5. Click on your business name to display your profile in DSBS
6. Click the Tools icon at the top right and click Print, or otherwise locate the Print function

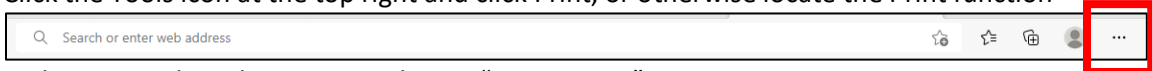

7. In the printer drop down menu, choose “Save as PDF”
8. Click “More settings”
 - a. Under Options, make sure the box beside “Headers and footers” is selected

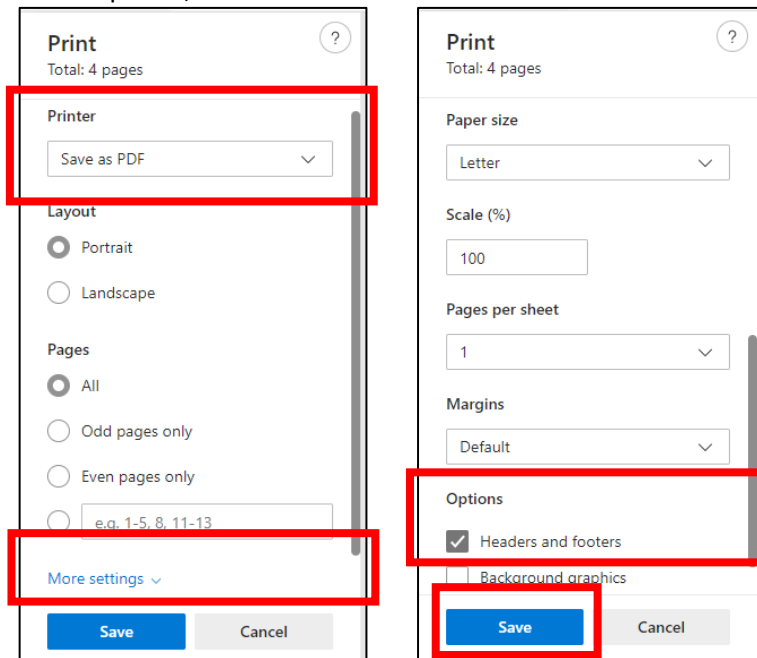

9. Click Save

HUBZone

Sample [SAM.gov](#) profile (pdf) with download date:

PDF must include the correct supplier name, the footer must include a print date within one year of previous year's HUBZone anniversary date and the HUBZone expiration date must be blank.

Last updated by [REDACTED] on Oct 28, 2022 at 06:08 PM



[REDACTED]

Unique Entity ID [REDACTED]	CAGE / NCAGE [REDACTED]	Purpose of Registration All Awards
Registration Status Active Registration	Expiration Date Oct 28, 2023	
Physical Address [REDACTED] [REDACTED] [REDACTED]	Mailing Address [REDACTED] [REDACTED] [REDACTED]	

Business Information

Doing Business as [REDACTED]	Division Name [REDACTED]	Division Number [REDACTED]
Congressional District [REDACTED]	State / Country of Incorporation [REDACTED]	URL [REDACTED]

Registration Dates

Activation Date Nov 1, 2022	Submission Date Oct 28, 2022	Initial Registration Date Jan 11, 2013
--------------------------------	---------------------------------	---

Entity Dates

Entity Start Date Jul 3, 2012	Fiscal Year End Close Date Dec 31
----------------------------------	--------------------------------------

Immediate Owner

CAGE [REDACTED]	Legal Business Name [REDACTED]
--------------------	-----------------------------------

Highest Level Owner

CAGE [REDACTED]	Legal Business Name [REDACTED]
--------------------	-----------------------------------

Executive Compensation

Registrants in the System for Award Management (SAM) respond to the Executive Compensation questions in accordance with Section 8202 of P.L. 110-252, amending the Federal Funding Accountability and Transparency Act (P.L. 109-282). This information is not displayed in SAM. It is sent to USAspending.gov for display in association with an eligible award. Maintaining an active registration in SAM demonstrates the registrant responded to the questions.

Proceedings Questions

Registrants in the System for Award Management (SAM.gov) respond to proceedings questions in accordance with FAR 62.208-7, FAR 62.208-8, or 2. C.F.R. 200 Appendix XII. Their responses are displayed in the responsibility/qualification section of SAM.gov. Maintaining an active registration in SAM.gov demonstrates the registrant responded to the proceedings questions.

Exclusion Summary

Active Exclusions Records?
No

SAM Search Authorization

I authorize my entity's non-sensitive information to be displayed in SAM public search results:
Yes

Entity Types

Business Types	Entity Type	Organization Factors
Entity Structure Corporate Entity (Not Tax Exempt)	Business or Organization	Limited Liability Company
Profit Structure For Profit Organization		

Jan 01, 2023 06:10:46 PM GMT
[https://sam.gov/entity/\[REDACTED\]](https://sam.gov/entity/[REDACTED])

Page 1 of 4

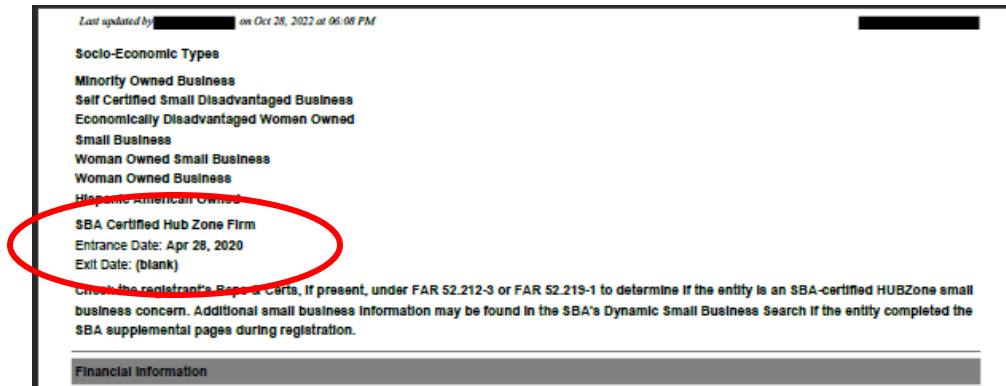

Instructions for capturing the full profile and download date from the SAM.gov website (Microsoft Edge):

1. Navigate to the [SAM.gov](https://sam.gov) website and login.
2. From the Home page, enter your UEI in the search box and click the magnifying glass to initiate the search

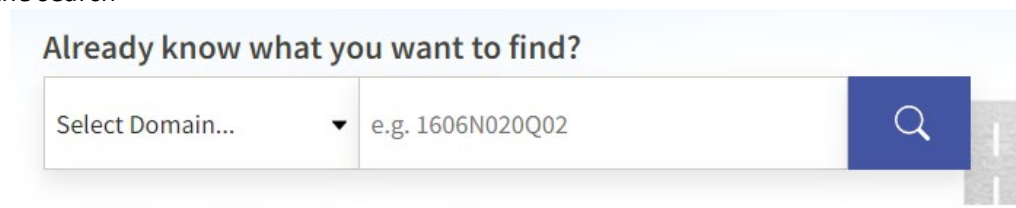

3. Click on your business name to display your profile
4. Click on the word "download" above and to the right of your business name

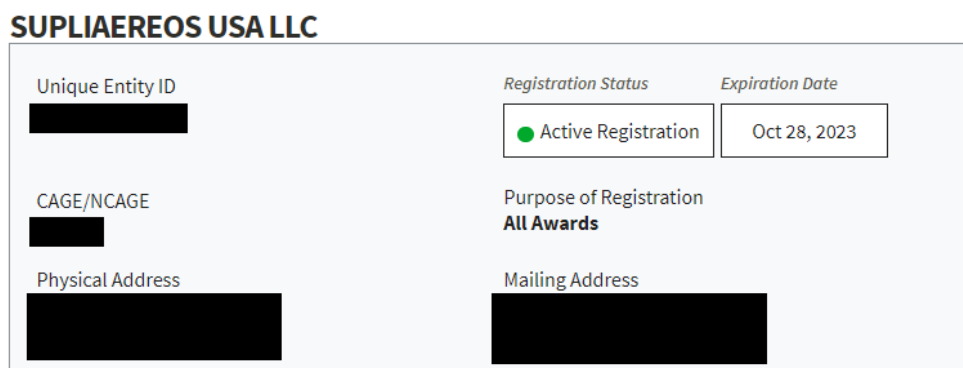

5. Select your file type by clicking the .pdf box
6. Click the "DOWNLOAD" button
7. There will be a pop-up in the upper right corner of your web browser when the download is complete. Click the "Open" button
8. Save the PDF file

**Certified Disability-Owned Business Enterprise (DOBE)
Disability: IN**

Validation: Certificate must include the correct supplier name, certificate number, and date of expiration that has not passed.

Note: Service-Disabled Veteran-Owned certificate issued by Disability: IN is an acceptable artifact for DOBE certification.



**Certified LGBT-Owned Business Enterprise
National LGBT Chamber of Commerce (NGLCC)**

Validation: Certificate must include the correct supplier name, certificate number, and date of expiration that has not passed.



**Certified Minority-Owned (U.S.)
National Minority Supplier Development Council (NMSDC)**

Validation: Certificate must include the correct supplier name, certificate number, and date of expiration that has not passed.



**Certified Minority-Owned (Non-U.S.)
NMSDC Affiliates**

Validation: Certificate from NMSDC affiliate must include the correct supplier name, certificate number, and date of expiration that has not passed.

NMSDC International Affiliates

- Canadian Aboriginal and Minority Supplier Council (CAMSC)
 - <http://www.camsc.ca/>
- Centro de Integracao de Negocios Brazil (INTEGRARE)
 - <https://www.integrare.org.br/>
- Minority Supplier Development UK (MSD-UK)
 - <http://www.msduk.org.uk>
- Minority Supplier Development China (MSD-China)
 - <https://msdchina.org.cn/>
- South African Supplier Diversity Council (SADC)
 - <https://www.sasdc.org.za/>
- Supply Nation (Australia)
 - <https://supplynation.org.au/>

**Certified Women-Owned (U.S.)
Women's Business Enterprise National Council (WBENC)**

Validation: Certificate must include the correct supplier name, certificate number, and date of expiration that has not passed.

Note: WOSB certificate issued by WBENC is an acceptable artifact for WBENC certification.

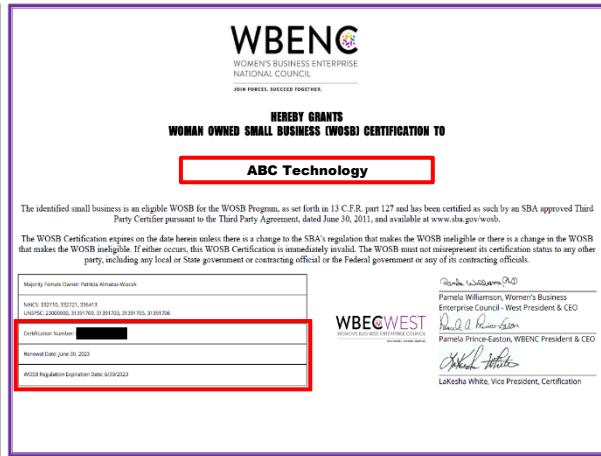

**Certified Women-Owned (Non-U.S.)
WEConnect International**

Validation: Certificate must include the correct supplier name, certificate number, and date of expiration that has not passed.



**Certified Veteran-Owned
National Veteran Business Development Council (NVBDC)**

Validation: Certificate must include the correct supplier name, certificate number, and date of expiration that has not passed



Supplier Business Size & Diversity Classifications

Category	Definition
AbilityOne	A U.S. business concern that is affiliated with AbilityOne. AbilityOne partners provide employment opportunities for people who are blind or have significant disabilities to deliver high quality, mission-essential products and services to Federal agencies in quality employment opportunities(www.abilityone.gov).
Disability-Owned	Disability-Owned Business Enterprise (DOBE): A business that is certified by Disability: IN. A disability-owned business enterprise (DOBE) is a for-profit business that is at least 51% owned, managed and controlled by a person with a disability regardless of whether or not that business owner employs person(s) with a disability. We do not certify non-profit organizations. www.disabilityin.org .
Historically Black Colleges & Universities/Minority Institutions (HBCU/MI)	HBCUs are institutions that were established before 1964 and have a principal mission that was, and is, the education of Black Americans. MIs are institutions that substantially increase the higher education opportunities for minority and/or low-income students who are educationally disadvantaged or underrepresented in post-secondary education. HBCUs and MIs must meet the requirements of Title 34 of the CFR, Parts 608.2 and 607.2, respectively.
HUBZone Small Business	SBA-Certified HUBZone SB: A business certified by the SBA as a HUBZone Small Business.
LGBT-Owned	LGBT-Owned Business Enterprise (LGBTBE): A business that is certified by the National LGBT Chamber of Commerce (NGLCC). A LGBT-Owned Business Enterprise (LGBTBE) is majority (at least 51%) owned, operated, managed, and controlled by an LGBT person or persons who are either U.S. citizens or lawful permanent residents Exercises independence from any non-LGBT business enterprise. www.nglcc.org .
Minority Owner Ethnicity	<ul style="list-style-type: none"> • Asian Pacific American: Persons with origins from Burma, Thailand, Malaysia, Indonesia, Singapore, Brunei, Japan, China (including Hong Kong), Taiwan, Laos, Cambodia (Kampuchea), Vietnam, Korea, The Philippines, U.S. Trust of Territory of the Pacific Islands (Republic of Palau), Republic of the Marshall Islands, Federated States of Micronesia, the Commonwealth of the Northern Mariana Islands, Guam, Samoa, Macao, Fiji, Tonga, Kiribati, Tuvalu, or Nauru. • African American: Persons with origins in any of the black racial groups of Africa. • Hispanic American: Persons of Cuban, Mexican, Puerto Rican, South or Central American, or other Spanish culture or origin, regardless of race • Native American: American Indians, Eskimos, Aleuts or Native Hawaiians. • Subcontinent Asian American: Persons with origins from India, Pakistan, Bangladesh, Sri Lanka, Bhutan, the Maldives Islands or Nepal.

Minority-Owned	A business that is at least 51 percent owned by one or more minorities; or in the case of any publicly owned business, at least 51% of the stock is owned by one or more minorities; and whose management and daily business operations are controlled by one or more minorities.
Certified Minority-Owned	<ul style="list-style-type: none"> • U.S.: A minority-owned business that is certified by the National Minority Supplier Development Council (NMSDC) www.nmsdc.org. • Non-U.S.: A minority-owned business that is certified by, CAMSC (Canada) http://www.camsc.ca/, MSD-UK (United Kingdom) http://www.msduk.org.uk, MSD-China (China) https://msdchina.org.cn/, Supply Nation (Australia) https://supplynation.org.au/, SADC (South Africa) https://www.sasdc.org.za/, INTEGRARE (Brazil) https://www.integrare.org.br/, or Other NMSDC affiliates.
Non-U.S. Small, Micro, Medium & Large	To be applied based on country size designations of the supplier entity
Small Disadvantaged Business (SDB)	<p>A business concern: (refer to: http://www.gpoaccess.gov/cfr/retrieve.html)</p> <ol style="list-style-type: none"> 1. that qualifies as “small” per the SBA Table of Small Business Size Standards Matched to North American Industry Classification System Codes. (https://www.sba.gov/federal-contracting/contracting-guide/size-standards) and 2. that is at least 51% unconditionally owned by one or more U.S. citizens who are socially & economically disadvantaged individuals and 3. whose management and daily business operations are controlled by one or more U.S. citizens who are socially and economically disadvantaged individuals and 4. the personal net worth of each individual claiming economic disadvantage is less than \$850,000 (Except for tribes, ANCs, CDCs and NHOs,). 5. All current Participants in the 8(a) BD program qualify as SDBs per 13 CFR 124.1001(b). <p>Note: ANCs, NHOs, or CDCs, must meet the "ownership", "management", and "control" criteria in Title 13 of the Code of Federal Regulations, Part 124.109, 124.110 and 124.111, respectively.</p>
U.S. Small Business	A US supplier that is independently owned and operated, is not dominant in the field of operations in which it is bidding and meets the NAICS size standards as prescribed in (http://www.census.gov/epcd/naics02/naicod02.htm and Code of Federal Regulations, Title 13, Part 121).
Veteran-Owned	A business that is at least 51% owned by one or more veterans, or in the case of any publicly owned business, at least 51% of the stock is owned by one or more veterans, and whose management and daily business operations are controlled by one or more veterans. Veteran means a person who served in the active military, naval, or air service, and who was discharged or released there from under conditions other than dishonorable as defined in 38 U.S.C. 101 (2.) http://www.vetbiz.gov

Service-Disabled Veteran-Owned	A business that is at least 51% owned by one or more service-disabled veterans, or in the case of any publically owned business, at least 51% of the stock is owned by one or more service disabled veterans and whose management and daily business operations are controlled by one or more service-disabled veterans or the spouse or permanent caregiver of a service-disabled veteran with permanent and severe disability. Servicedisabled veteran means a veteran, as defined in 38 U.S.C. 101(2), with a disability that is service connected, as defined in 38 U.S.C. 101(16).
NVBDC-Certified	A business that is certified by the National Veterans Business Development Council (NVBDC). https://nvbdc.org/
Women-Owned	A business that is at least 51 % owned by one or more women; or, in the case of any publicly owned business, at least 51% of the stock is owned by one or more women; and whose management and daily business operations are controlled by one or more women.
Certified Women-Owned	<ul style="list-style-type: none"> • U.S.: A women-owned business that is certified by Women's Business Enterprise National Council (WBENC) http://www.wbenc.org • Non-U.S.: A women-owned business that is certified by WEConnect International http://www.weconnectinternational.org